

RIVAGE

BAL HARBOUR

RESIDENCE
A
FLOOR
2

4 BEDROOMS
5 BATHROOMS
POWDER ROOM
DEN / SERVICE

INTERIOR
4,784 SF | 444 SQM

EXTERIOR
388 SF | 36 SQM

TOTAL
5,172 SF | 480 SQM

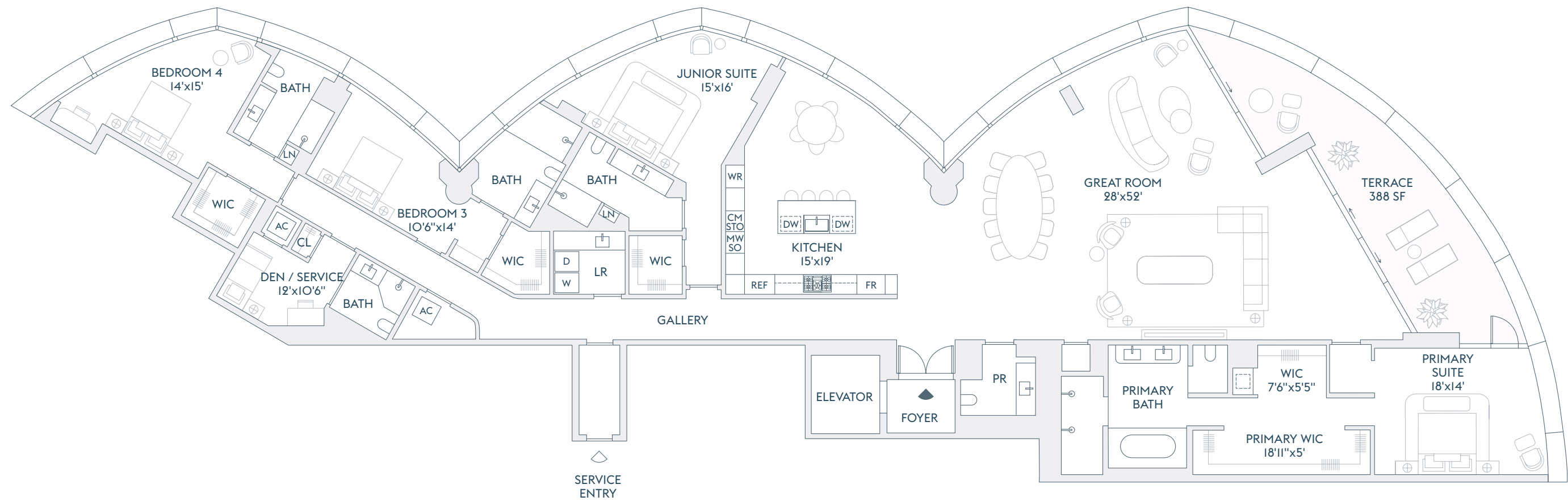

INTRACOASTAL
WATERS

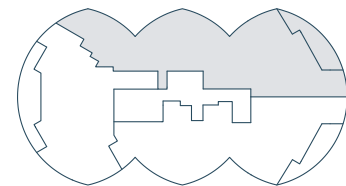

ATLANTIC OCEAN

The dimensions stated for this floor plan are approximate because there are various recognized methods for calculating the square footage of a unit. The square footage stated here is calculated from the exterior boundaries of the exterior walls to the centerline of interior demising walls without deductions for cutouts, curves, or architectural features. This method typically results in quoted dimensions greater than the dimensions that would be determined by using other accepted methods. The definition of "Unit" and the calculation method to be relied upon is set forth by the Developer in Developer's prospectus which method may result in a square footage calculation less than the result of the calculation method used here. Renderings depict features not included with purchase, but which are available at an additional cost such as wine bar and closet millwork among others. Consult the Developer's prospectus to learn what is included with Unit purchase and to understand Unit dimensions. 2023 © Carlton Terrace Owner LLC, with all rights reserved.

RIVAGE

BAL HARBOUR

RESIDENCE
B

FLOOR
2

4 BEDROOMS
5 BATHROOMS
POWDER ROOM
DEN / SERVICE

INTERIOR
4,215 SF | 392 SQM

EXTERIOR
388 SF | 36 SQM

TOTAL
4,603 SF | 428 SQM

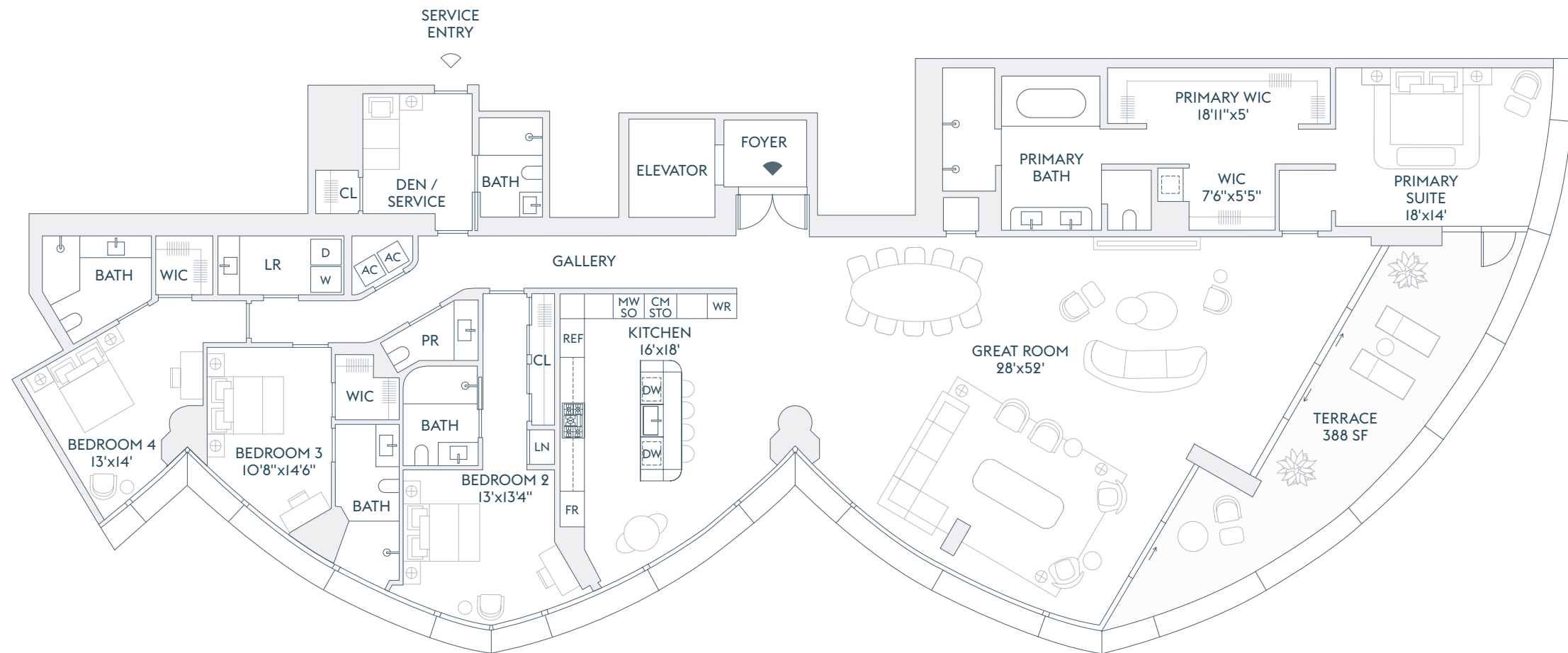

INTRACOASTAL
WATERS

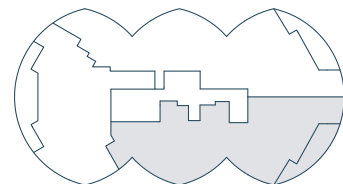

ATLANTIC OCEAN

The dimensions stated for this floor plan are approximate because there are various recognized methods for calculating the square footage of a unit. The square footage stated here is calculated from the exterior boundaries of the exterior walls to the centerline of interior demising walls without deductions for cutouts, curves, or architectural features. This method typically results in quoted dimensions greater than the dimensions that would be determined by using other accepted methods. The definition of "Unit" and the calculation method to be relied upon is set forth by the Developer in Developer's prospectus which method may result in a square footage calculation less than the result of the calculation method used here. Renderings depict features not included with purchase, but which are available at an additional cost such as wine bar and closet millwork among others. Consult the Developer's prospectus to learn what is included with Unit purchase and to understand Unit dimensions. 2023 © Carlton Terrace Owner LLC, with all rights reserved.



RIVAGE

BAL HARBOUR

RESIDENCE FLOOR

C 2

3 BEDROOMS
3 BATHROOMS
POWDER ROOM

INTERIOR
3,284 SF | 305 SQM

EXTERIOR
585 SF | 54 SQM

TOTAL
3,869 SF | 359 SQM

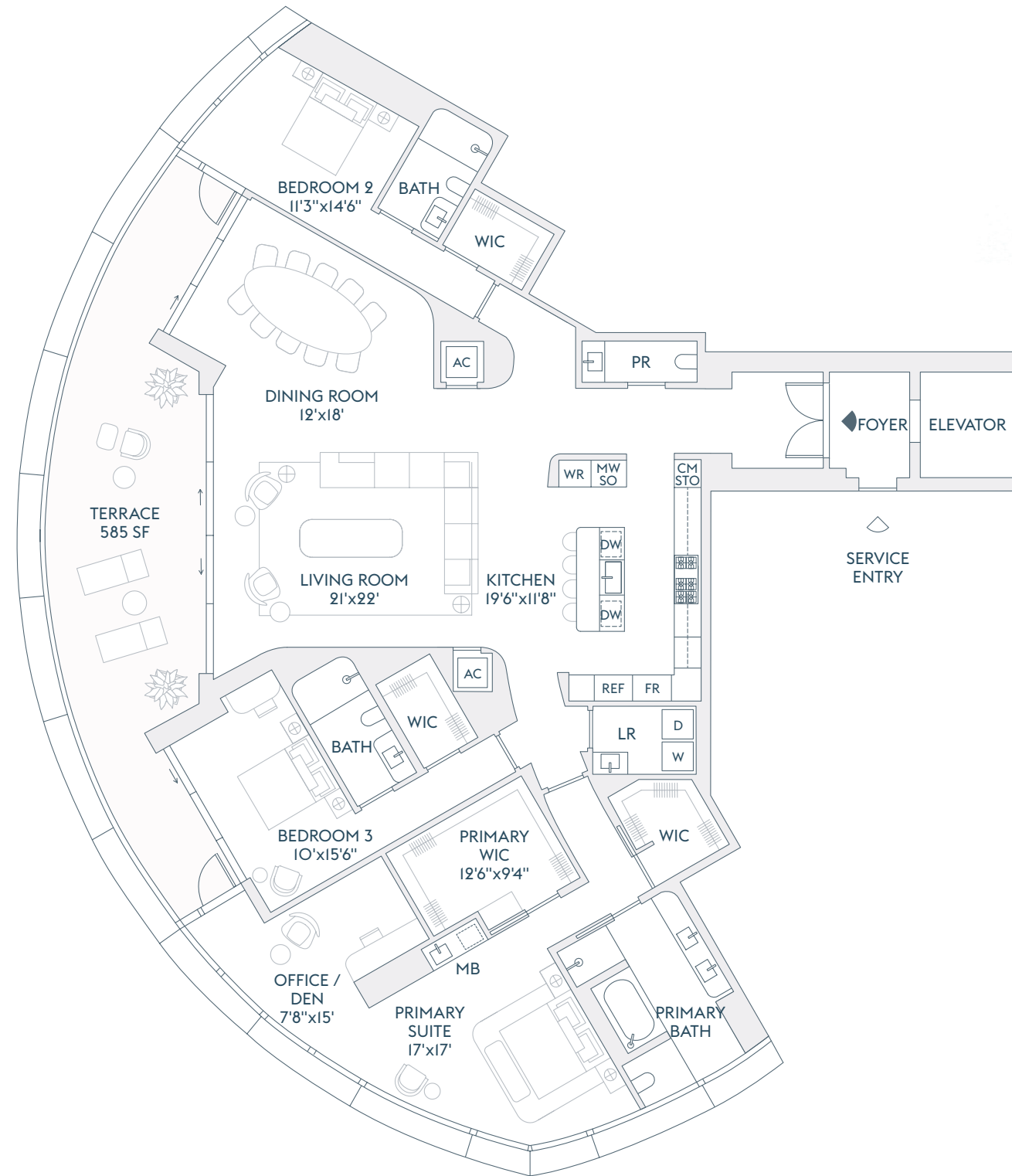

INTRACOASTAL
WATERS

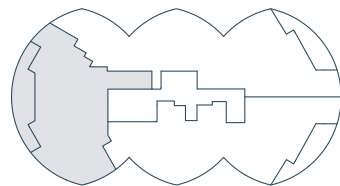

ATLANTIC OCEAN

The dimensions stated for this floor plan are approximate because there are various recognized methods for calculating the square footage of a unit. The square footage stated here is calculated from the exterior boundaries of the exterior walls to the centerline of interior demising walls without deductions for cutouts, curves, or architectural features. This method typically results in quoted dimensions greater than the dimensions that would be determined by using other accepted methods. The definition of "Unit" and the calculation method to be relied upon is set forth by the Developer in Developer's prospectus which method may result in a square footage calculation less than the result of the calculation method used here. Renderings depict features not included with purchase, but which are available at an additional cost such as wine bar and closet millwork among others. Consult the Developer's prospectus to learn what is included with Unit purchase and to understand Unit dimensions. 2023 © Carlton Terrace Owner LLC, with all rights reserved.

RIVAGE

BAL HARBOUR

OCEAN PENTHOUSE FLOORS

A 23, 24, 25

- 5 BEDROOMS
- 7 BATHROOMS
- 3 POWDER ROOMS
- DEN / SERVICE
- MEDIA ROOM
- GAME ROOM
- LIBRARY / LOUNGE
- FITNESS STUDIO
- OUTDOOR KITCHEN
- POOL
- PRIVATE ELEVATOR

INTERIOR
12,603 SF | 1,171 SQM

EXTERIOR
4,918 SF | 457 SQM

TOTAL
17,521 SF | 1,628 SQM

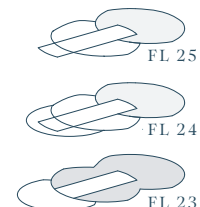
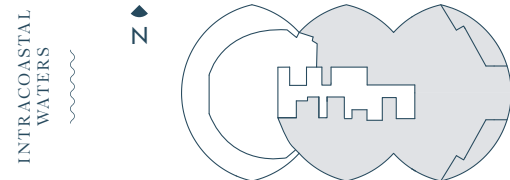
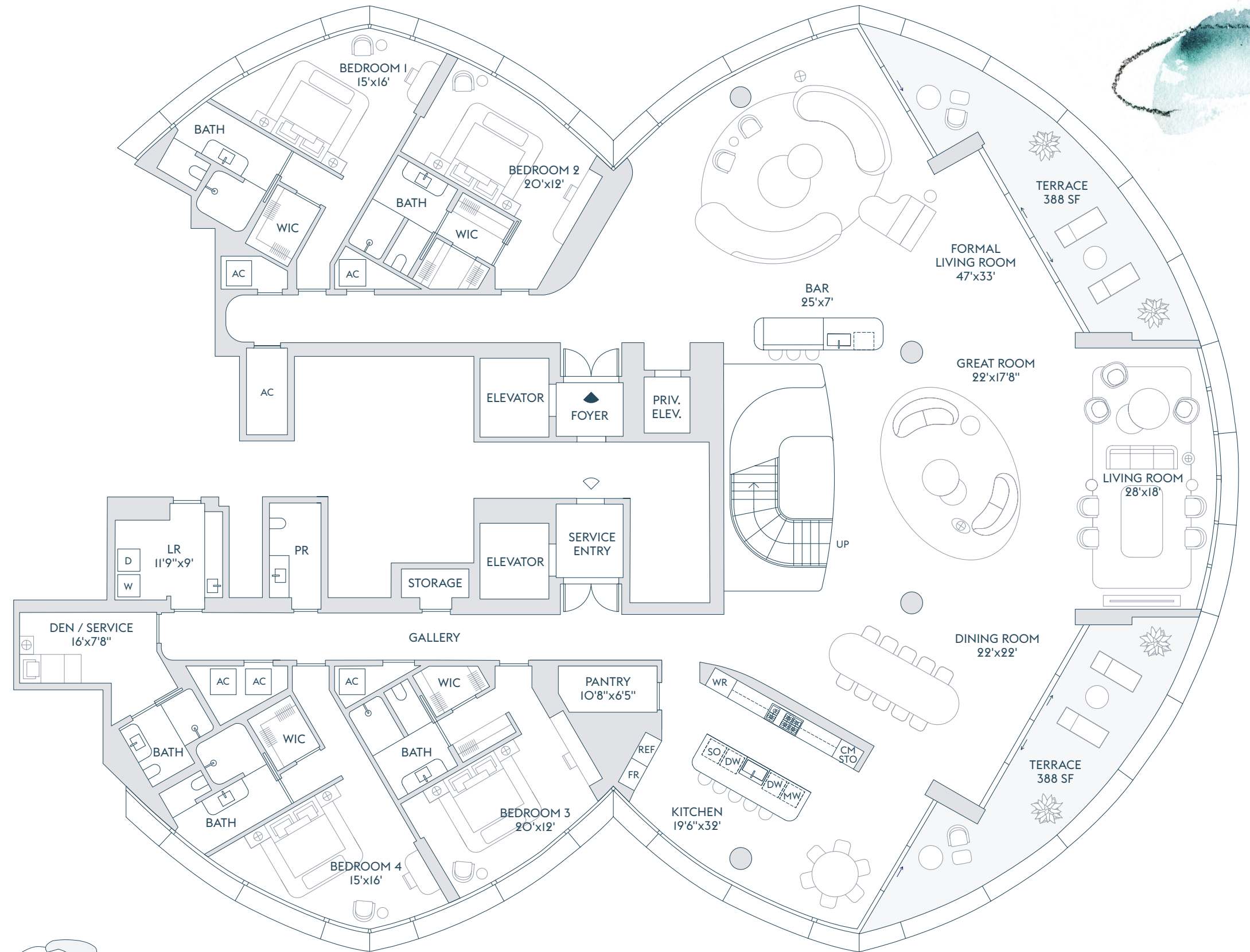

FLOOR 23

The dimensions stated for this floor plan are approximate because there are various recognized methods for calculating the square footage of a unit. The square footage stated here is calculated from the exterior boundaries of the exterior walls to the centerline of interior demising walls without deductions for cutouts, curves, or architectural features. This method typically results in quoted dimensions greater than the dimensions that would be determined by using other accepted methods. The definition of "Unit" and the calculation method to be relied upon is set forth by the Developer in Developer's prospectus which method may result in a square footage calculation less than the result of the calculation method used here. Renderings depict features not included with purchase, but which are available at an additional cost such as wine bar and closet millwork among others. Consult the Developer's prospectus to learn what is included with Unit purchase and to understand Unit dimensions. 2023 © Carlton Terrace Owner LLC, with all rights reserved.

RIVAGE

BAL HARBOUR

OCEAN PENTHOUSE FLOORS

A 23, 24, 25

- 5 BEDROOMS
- 7 BATHROOMS
- 3 POWDER ROOMS
- DEN / SERVICE
- MEDIA ROOM
- GAME ROOM
- LIBRARY / LOUNGE
- FITNESS STUDIO
- OUTDOOR KITCHEN
- POOL
- PRIVATE ELEVATOR

INTERIOR
12,603 SF | 1,171 SQM

EXTERIOR
4,918 SF | 457 SQM

TOTAL
17,521 SF | 1,628 SQM

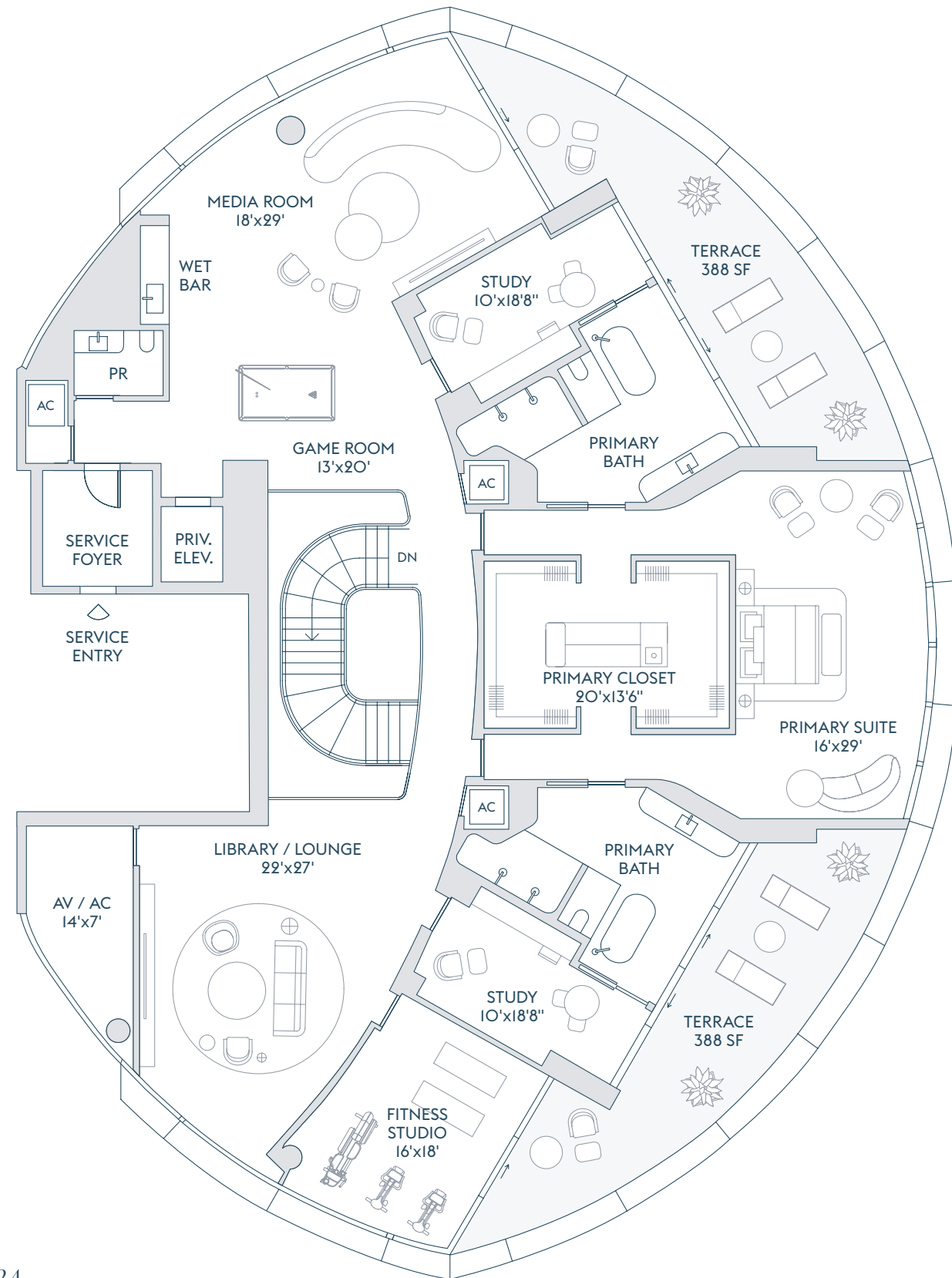

INTRACOASTAL WATERS

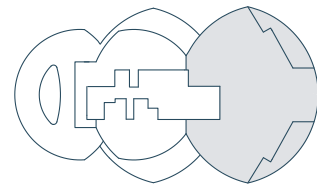

ATLANTIC OCEAN

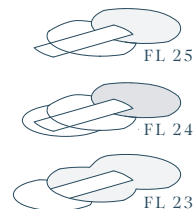

FLOOR 24

The dimensions stated for this floor plan are approximate because there are various recognized methods for calculating the square footage of a unit. The square footage stated here is calculated from the exterior boundaries of the exterior walls to the centerline of interior demising walls without deductions for cutouts, curves, or architectural features. This method typically results in quoted dimensions greater than the dimensions that would be determined by using other accepted methods. The definition of "Unit" and the calculation method to be relied upon is set forth by the Developer in Developer's prospectus which method may result in a square footage calculation less than the result of the calculation method used here. Renderings depict features not included with purchase, but which are available at an additional cost such as wine bar and closet millwork among others. Consult the Developer's prospectus to learn what is included with Unit purchase and to understand Unit dimensions. 2023 © Carlton Terrace Owner LLC, with all rights reserved.

RIVAGE

BAL HARBOUR

OCEAN
PENTHOUSE FLOORS

A 23, 24, 25

- 5 BEDROOMS
- 7 BATHROOMS
- 3 POWDER ROOMS
- DEN / SERVICE
- MEDIA ROOM
- GAME ROOM
- LIBRARY / LOUNGE
- FITNESS STUDIO
- OUTDOOR KITCHEN
- POOL
- PRIVATE ELEVATOR

INTERIOR
12,603 SF | 1,171 SQM

EXTERIOR
4,918 SF | 457 SQM

TOTAL
17,521 SF | 1,628 SQM

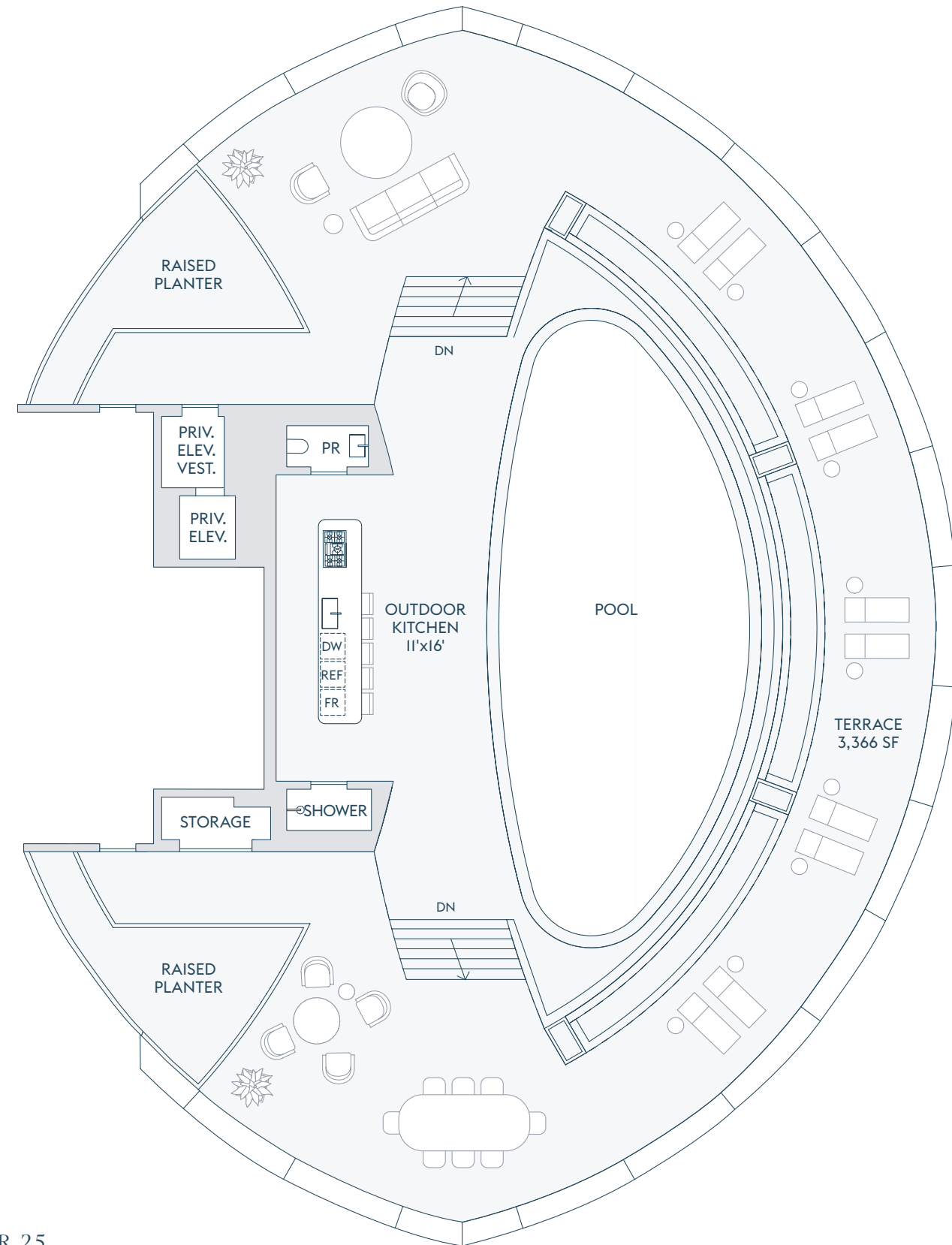

INTRACOASTAL
WATERS

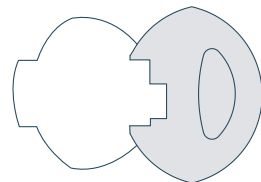

ATLANTIC OCEAN

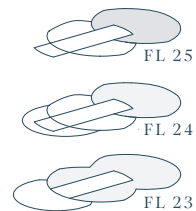

FLOOR 25

The dimensions stated for this floor plan are approximate because there are various recognized methods for calculating the square footage of a unit. The square footage stated here is calculated from the exterior boundaries of the exterior walls to the centerline of interior demising walls without deductions for cutouts, curves, or architectural features. This method typically results in quoted dimensions greater than the dimensions that would be determined by using other accepted methods. The definition of "Unit" and the calculation method to be relied upon is set forth by the Developer in Developer's prospectus which method may result in a square footage calculation less than the result of the calculation method used here. Renderings depict features not included with purchase, but which are available at an additional cost such as wine bar and closet millwork among others. Consult the Developer's prospectus to learn what is included with Unit purchase and to understand Unit dimensions. 2023 © Carlton Terrace Owner LLC, with all rights reserved.